

## CTH3-A 900 T6 11kW F400 (279900106A)

### GENERAL DATA



#### ROOF FAN, AL COWL, 400°C/2h

##### MANUFACTURING FEATURES

- Roof cowl made of aluminium
  - Structure, roof base support and bird protection guard made of galvanised steel.
  - High efficiency backward impeller with self-cleaning system of steel.
  - Standard asynchronous motor with IP-55 protection and Class F insulation.
- Manufactured with standard voltages: 230V 50Hz in single phase motors, 230/400V 50Hz in three phase motors and 400V 50Hz in 2 speed motors

##### APPLICATIONS

Specially designed for roof installation, they are suitable for:

- Smoke extraction.
- Smoke emergency exhaust with motor outside the hazardous area.
- Air renewal in buildings and industries.
- Industrial and professional kitchen hoods.
- Maximum continuous working temperature: carried air 110°C, environment 60°C for three phase and 50°C for single phase motors.

##### UNDER REQUEST

- 60Hz and special voltages.
- Sparking proof fan with EEx\_d certified motor.

Official homologation by the European laboratory APPLUS according to EN 12101-3:2015  
Certification Nr: 0370-CPR-2656

### PERFORMANCE CURVE

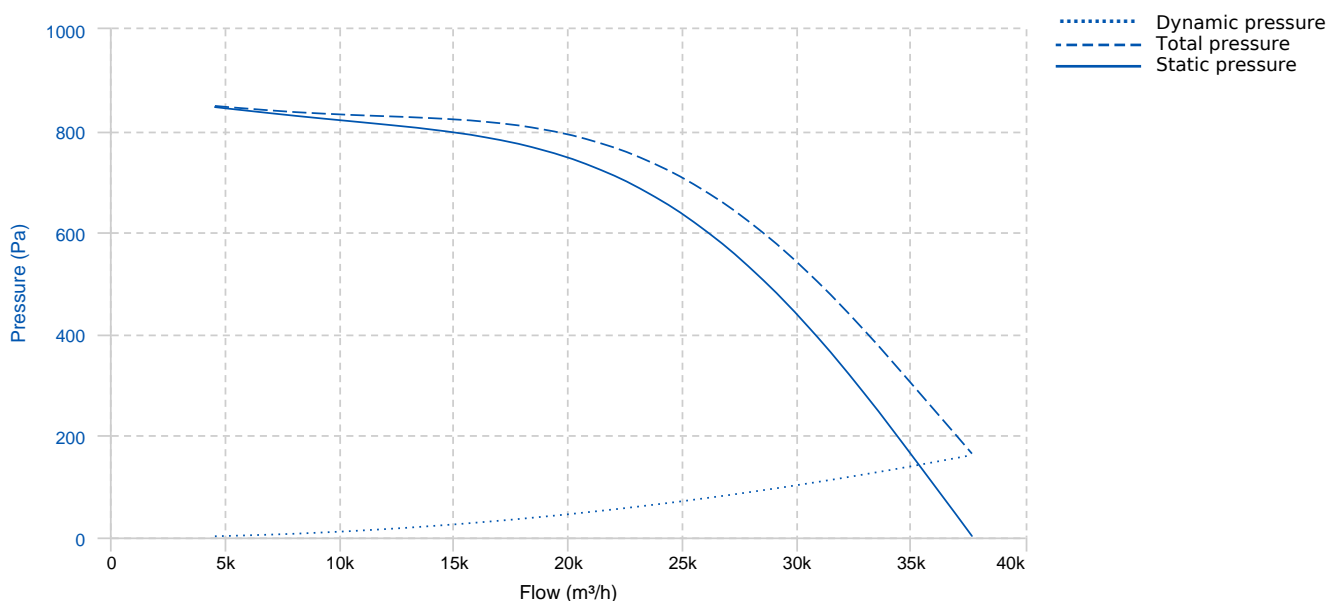

## TECHNICAL DATA

Fan							
RPM	965	Approx. weight	392 kg	Max. Flow	37660 m <sup>3</sup> /h		
Motor							
Power	11 kW	RPM	965	I max. (400V)	22,6 A	I max. (690V)	13,1 A
Size	160L	Approx. weight	130 kg	Efficiency (%)	90.3 %	FP	0.79

## ERP DATA

Fan data sheet		
Fan type	Unit for non-residential ventilation (LOT 6)	
Typology	Static	
reports.other	Outlet and Inlet free discharge	
Type of driver	None	
Motor power (kW)	11	
	Fan values	ERP Requirements 2018
Max. efficiency (%)	63.08	54.27
Effic. Heat recovery (%)	-	
Pabs (kW)	7.239	
Flow (m <sup>3</sup> /h)	23112.04	
Static pressure (Pa)	686.94	
Speed (m/s)	10.09	
SFP (W/m <sup>3</sup> /s)	1127.63	

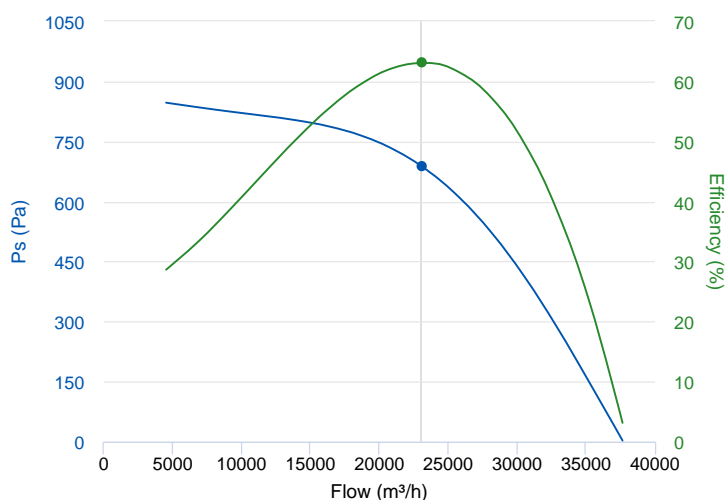

**DIMENSIONS**

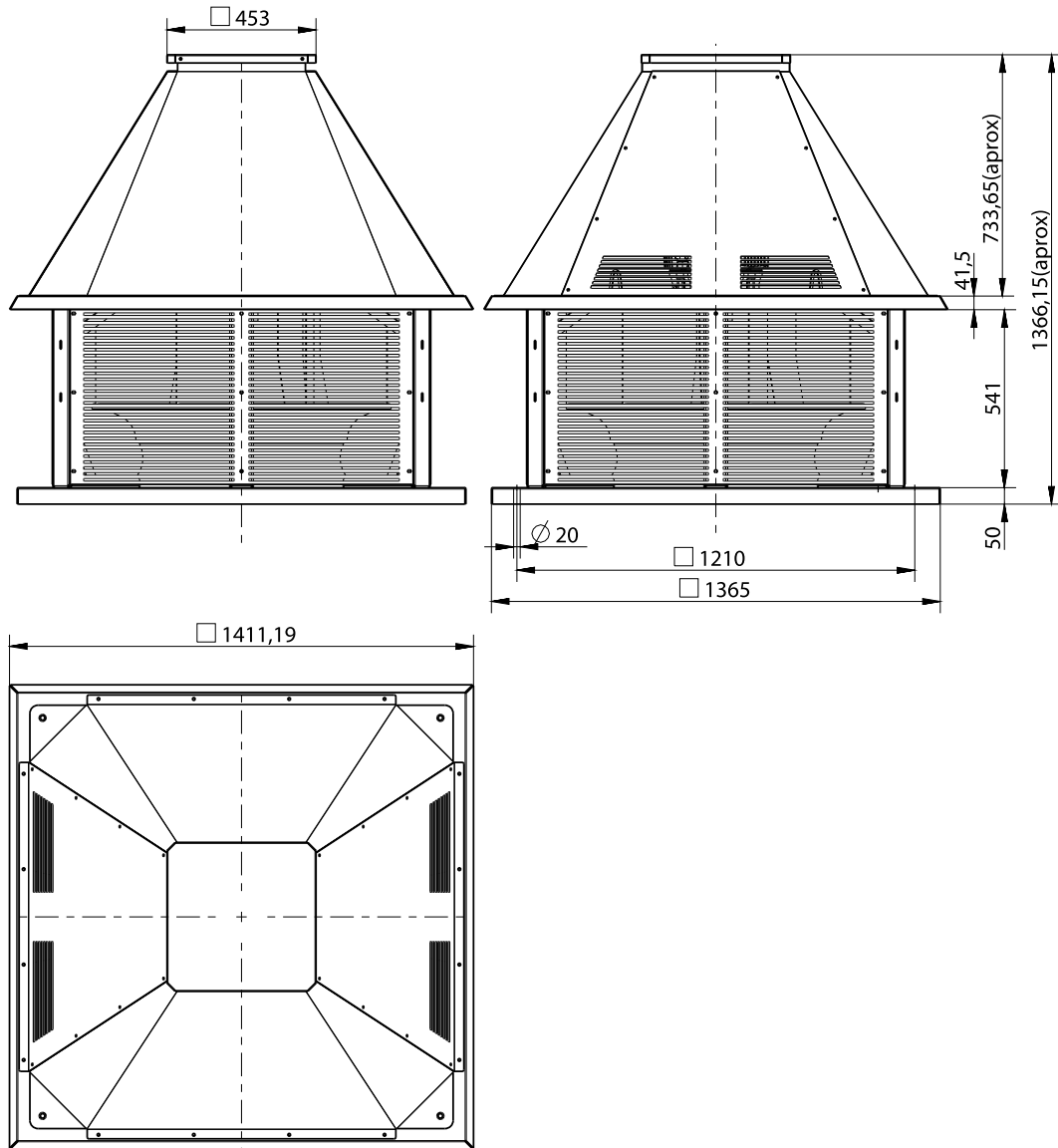

**Dimensions (mm)**

CTH3-A 900

## WIRING DIAGRAM

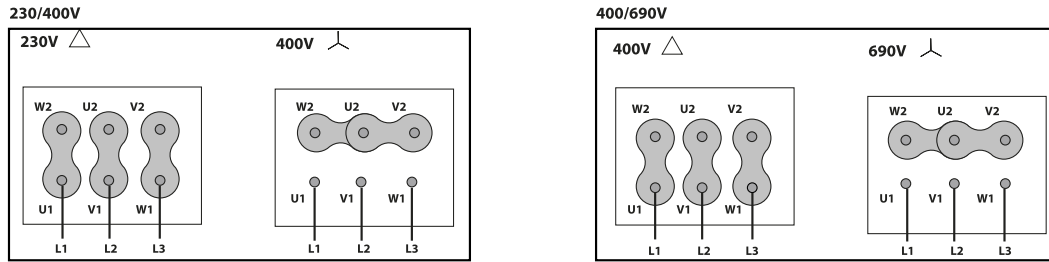

## ACCESSORIES



**SAFETY SWITCH**  
**INT 25 3P A**  
**REF: INT253PA**



**SAFETY SWITCH FOR 400°C/2h**  
**INT 400 63A 3P**  
**REF: 508906301**



**FREQUENCY SPEED CONTROLLER**  
**SFC 400 III 23A \***  
**REF: SFC400III23**

## SPARE PARTS

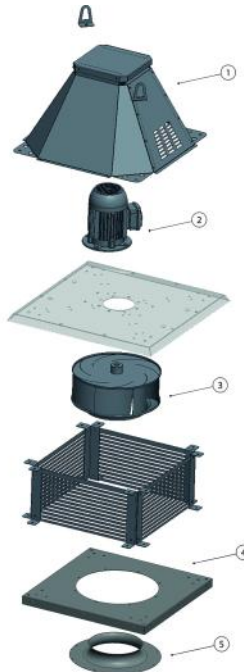

	Code	Model	Qty
1	R-279908491	ROOF COWL CTH3-A 900-1000	x1
2	721001282	MOTOR 11kW T6 B5 400/690V	x1
3	R-CTB-N902-42RD	IMPELLER Ø900 h=2 D42 RD	x1



	Code	Model	Qty
4	R-279901771	BASE CTH3 900	x1
5	R-279901681	INLET CONE CTH3 900	x1